

UNFORTUNATELY DUE TO THE FLIGHT OF THE ANIMAL AND THE FACT THAT YOUR PUPPY IS AROUND OTHER PUPPIES, UPPER RESPIRATORY CASES HAVE BECOME COMMON WITH DOGS FLYING TO DIFFERENT AREAS IN THE COUNTRY. THE COMMON SIGN ASSOCIATED WITH THIS IS A HACK OR A COUGH. **CLAVOMOX WILL NOT TAKE CARE OF THIS IRRITATION AS IT IS NOT KENNEL COUGH!!!** WE WANT TO ASSURE YOU THAT ALL PUPPIES COMING OUT OF OUR FACILITY WILL NOT BE LEAVING WITH SIGNS OF ANY KIND OF UPPER RESPIRATORY PROBLEMS!!! IF A PUPPY COMES TO YOU AND SHOWS SIGNS AFTER ARRIVAL, WE WANT YOU TO BE INFORMED OF THE QUICKEST AND CHEAPEST WAY TO TREAT YOUR PUPPY!!! FOR SOME REASON NOT MANY VETS KNOW THE BEST AND MOST EFFECTIVE TREATMENT FOR UPPER RESPIRATORY ISSUES, THAT IS WHY WE ARE NOW TRYING TO INFORM OUR CUSTOMERS OF THE BEST TECHNIQUE.

THE BEST WAY TO TREAT UPPER RESPIRATORY IN SMALL PUPPIES IS WITH A NEBULIZER WITH SALINE SOLUTION COMBINED WITH AN ORAL EXPECTERENT!!!

PUPPIES REQUIRE A 6 DAY TREATMENT USEING 2CC OF SALINE PER DAY ADMINISTERED VIA THE NEBULIZER

FOR \$75 WE WILL PRIORITY MAIL YOU THE NEBULIZER AND SALINE, AS WELL AS ORAL EXPEXTERENT (PINK) & ORAL HERBAL REMEDY (SIMILAR TO AIRBORNE). WHEN NEBULIZER IS RETURNED WE WILL CREDIT YOUR CARD BACK THE \$75 DEPOSIT!

AFTER USE OF NEBULIZER PLEASE RETURN TO:

AFFORDABLE PUPS
13326 MILLER RD
JOHNSTOWN, OH 43031

INSTRUCTIONS

1. TAKE NEBULIZER OUT OF BOX, INSTRUMENTS & SALINE SOLUTION (CLEAR SYRENGES IN BAGGIE)
2. BEGAN ASSEMBLY OF NEBULIZER, THE IMAGES WILL ASSIST YOU WITH THIS, IMAGES ORDER LEFT TO RIGHT

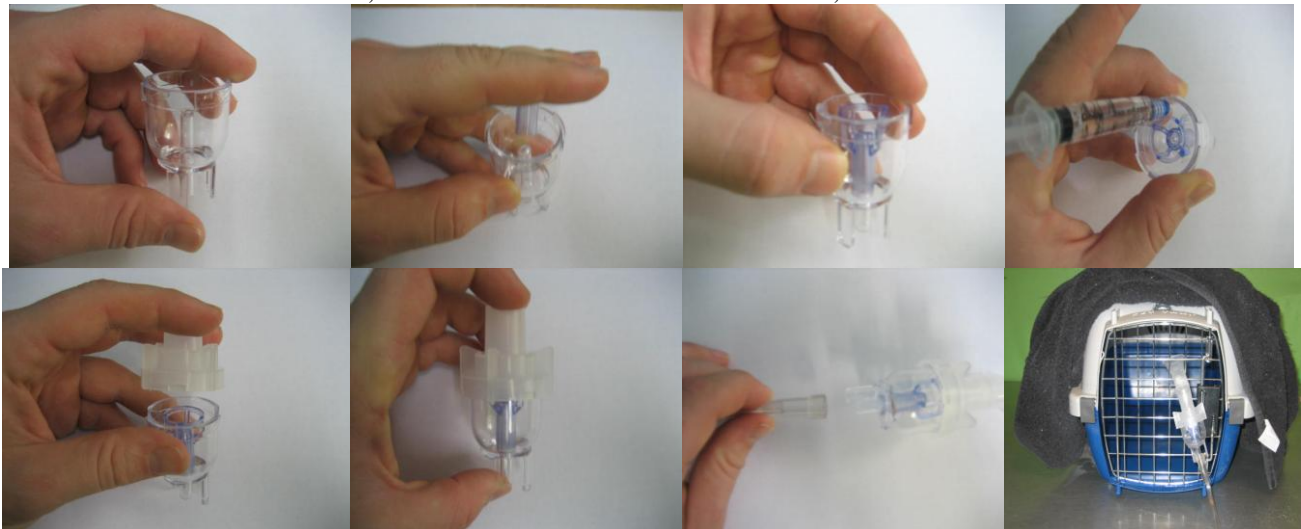

3. ATTENTION TO IMAGE 4 THIS IS WHERE YOU ADD THE SALINE, DO NOT GET SALINE ON PURPLE INSERT; ALL THE SALINE SOLUTION MUST BE KEPT IN THE PART FOUND IN IMAGE 1. ADD 2cc's ONLY. USE EMPTY SYRENGE AND ADD 6 ML OF TAP WATER IN THE SAME LOCATION.
4. WHEN SALINE & WATER HAVE BEEN ADDED AND TOP CAP HAS BEEN TIGHTENED ON (IMAGE 6) MAKE SURE YOU HOLD THE NEBULIZER UPRIGHT (IMAGE 6), THEN INSERT PLASTIC TUBE INTO BOTTOM OF NEBULIZER (IMAGE 7)
5. PUT PUPPY INTO KENNEL CAB THAT WAS SENT WITH THE PUPPY WHEN IT ARRIVED AT THE AIRPORT
 - TAKE A FULL SIZE TOWEL AND COVER THE CAGE, TAKE THE MOUTH PIECE (ONLY PIECE NOT ATTACHED YET) AND PUT IT THROUGH THE GRATE OF THE CAGE, THEN ATTACH THE NEBULIZER (IMAGE 8).
 - TAKE THE TOWEL AND COVER THE REST OF THE GRATE SO THAT NONE OF THE MIST FROM THE NEBULIZER CAN ESCAPE THE CAGE.
6. TURN MACHINE ON, LET PUPPY SIT IN CAGE FOR 30 MIN, THIS ALLOWS THE PUPPIES LUNGS TO ABSORB ALL OF THE MOISTURE

AFTER TREATMENT TAKE NEBULIZER APART AND RINSE IT OFF COMPLETELY, BLOW OFF ALL COMPONENTS TO MAKE SURE NOTHING WILL BE CLOGGED UP FOR NEXT TREATMENT!!!!